

SPR Barrel Profile

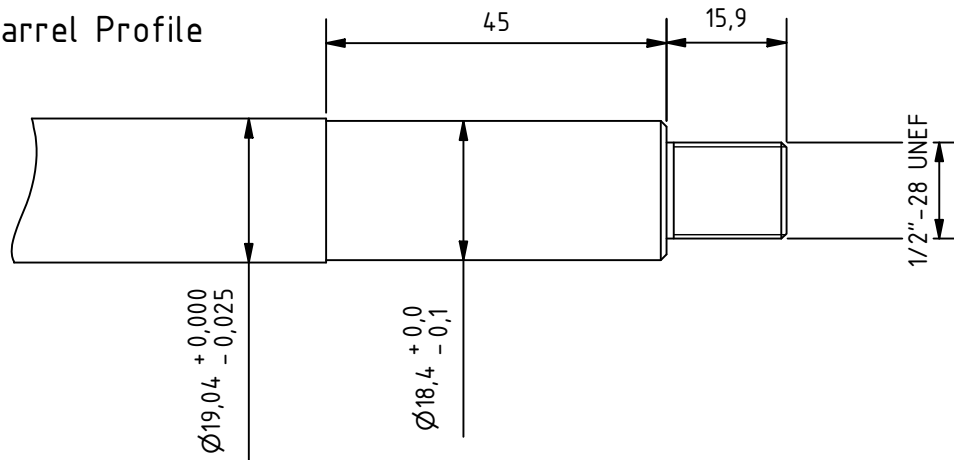

1. Not all barrels are made to OPS Inc. / Allen Engineering specs.
2. If your barrel is not in spec, a custom collar must be made to fit your barrel and sit at the correct distance to the muzzle brake. If your barrel does not have a locating shoulder for the collar to rest against, the barrel must be machined. Without a shoulder, the suppressor will push the collar back onto the barrel.

Brake & Collar Assembly

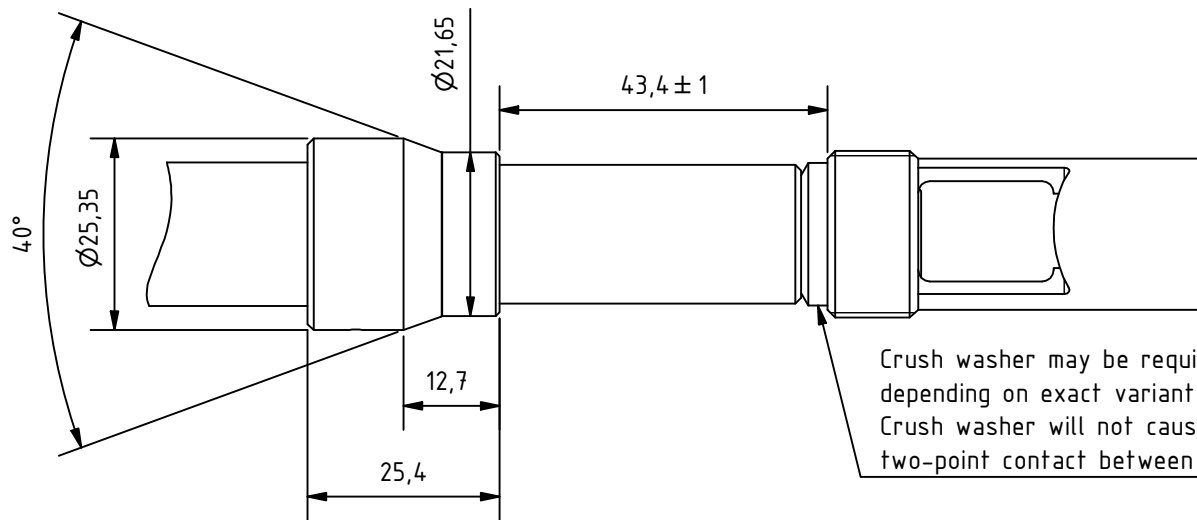

Crush washer may be required to achieve correct distance to collar, depending on exact variant of muzzle brake. Crush washer will not cause alignment issues due to two-point contact between suppressor and barrel.

Created R. Demarmels 09.09.2024	Material	Weight -	Surface Treatment & Finish			
Checked	Standard Tolerances ISO 2768 - mK	Document Type Technical Drawing	Scale 1 : 1	Sheet 1/1	Format A4	Units mm / deg / g
Approved	Designation SPR Collar Details		Drawing Number 110020040		Index	
<p>This document is intended to provide supplementary product information regarding the installation of the Acheron SPR ES suppressor. If the information provided is not sufficient, you need to consult a professional. Modification of firearms may be subject to legal restrictions depending on local laws. The author is not liable for any damages resulting from the use of the information provided in this document.</p>						